

hanskonner
professionelle qualität

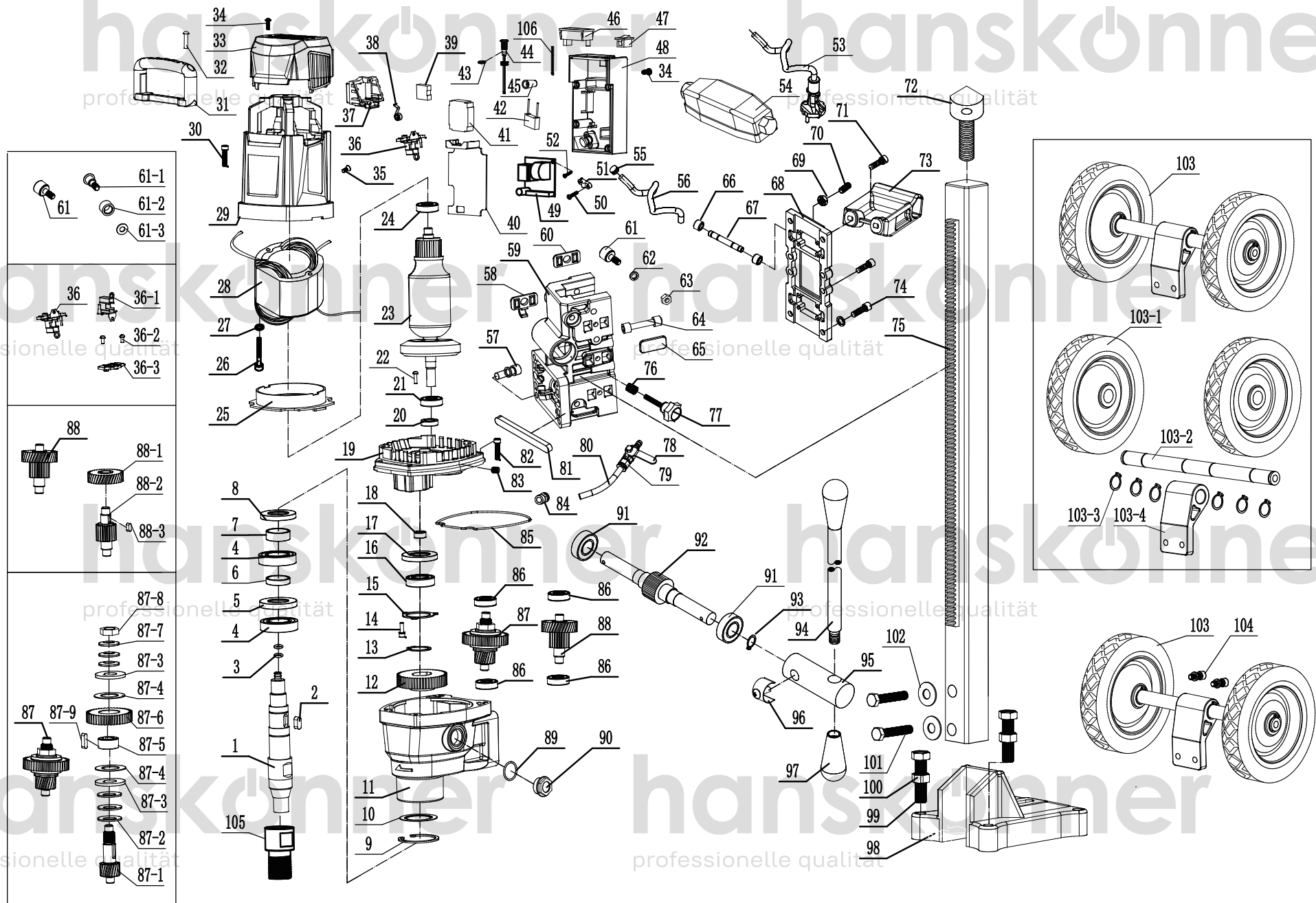

hanskonner
professionelle qualität

hanskonner
professionelle qualität

hanskonner
professionelle qualität

hanskonner
professionelle qualität

hanskonner
professionelle qualität

HBD395

NO.	DESCRIPTION	QTY	NO.	DESCRIPTION	QTY	NO.	DESCRIPTION	QTY	NO.	DESCRIPTION	QTY
1	OUTPUT SPINDLE	1	36-1	BRUSH HOLDER	2	67	GUIDE ROD	2	91	BEARING 6003	2
2	SQUARE KEY 8*6*18	2	36-2	HOLLOW RIVET	2	68	LIFT COVER	1	92	LIFTING GEAR SHAFT	1
3	O RING	2	36-3	BRUSH BOARD	2	69	NUT M8	5	93	BEAD FLANGEΦ17	2
4	BEARING 6006	2	37	BRUSH SEAT	2	70	SCREW M8*20	5	94	OPERATING PLOES	1
5	OIL SEAL	1	38	BRUSH COIL SPRING	2	71	SCREW M6*35	4	95	SLEEVE	1
6	SPACER SLEEVE	1	39	CARBON BRUSH	2	72	TOP SCREW	1	96	BUCKLE	1
7	SPACER SLEEVE	1	40	OPENING COVER	1	73	SUPPORT HANDLE	1	97	SHAKE HANDLE BALL	2
8	OIL SEAL	1	41	OVERLOAD PROTECTOR	1	74	SCREW M8*20	4	98	BASE	1
9	FULLER FAUCET	1	42	CAPACITOR	1	75	UPRIGHT POST	1	99	SCREW M16*75	4
10	DUST COVER	1	43	O RING Φ11*Φ8*1.5	1	76	SPRING	1	100	SCREW M16	4
11	HEAD SHELL	1	44	WARNING LIGHT	1	77	ROSE	1	101	SCREW M12*65	2
12	BIG GEAR	1	45	PRESSING CAP P3	5	78	FULLER FAUCET	1	102	GASKET	2
13	BEAD FLANGEΦ25	1	46	DIGITAL DISPLAY TABLE	1	79	AIR TUBE	1	103	WHEEL COMPONENT	1
14	SCREW M5*18	3	47	SWITCH	1	80	QUICK FITTING	1	103-1	WHEEL	2
15	FLANGE	1	48	SWITCH BOX	1	81	SQUARE KEY12*8*100	1	103-2	WHEEL CONNECTING ROD	1
16	BEARING 6004	1	49	PCB PLATE	1	82	SCREW M6*30	4	103-3	BEAD FLANGEΦ20	6
17	OIL SEAL	1	50	SCREW ST4*14	6	83	SCREW M8*8	1	103-4	WHEEL FIXED FRAME	1
18	BEARING INNER RING	1	51	WIRE BOARD	1	84	QUICK TWIST JOINT	1	104	SCREW M8*30	2
19	MIDDLE COVER	1	52	SCREW ST3*8	1	85	OIL GASKET Φ2.2	1	105	CONVERSION CONNECTER	1
20	OIL SEAL	1	53	PLUG	1	86	BEARING 6201	4	106	DATA CABLE	1
21	BEARING6202	1	54	EARTH LEAKAGE PROTECTION SWITCH	1	87	CLUTCH (MODULE)	1			
22	SCREW M5X10	2	55	CABLE SHEATH	1	87-1	GRADE 2 TOOTH AXIS	1			
23	ROTOR	1	56	SHORT CABLE	1	87-2	PLATE	3			
24	BEARING 6201	1	57	SCREW M8*35	4	87-3	PRESSURE PULL	2			
25	FAN SHROUD	1	58	DECORATIVE COVERS 3	1	87-4	WEARING PLATE	2			
26	SCREW M5*80	2	59	LIFT BODY	1	87-5	AXIAL SLEEVE	1			
27	RING Φ5	2	60	DECORATIVE COVERS 2	2	87-6	SECOND GEAR	1			
28	STATOR	1	61	GUIDE WHEEL SET	4	87-7	SPRING	2			
29	HOUSING	1	61-1	GUIDE WHEEL SHAFT	4	87-8	SCREW M16*1.5	1			
30	SCREWM6*40	4	61-2	STEEL SLEEVE	4	87-9	SQUARE KEY 6*6*22	1			
31	BACK HANDLE	1	61-3	GASKET	4	88	FIRST GEAR SHAFT ASSEMBLY	1			
32	SCREWST5*22	2	62	RING Φ8	4	88-1	FIRST GEAR	1			
33	REAR COVER	1	63	NUT M8	4	88-2	FIRST GEAR SHAFT	1			
34	SCREW M4*14	8	64	GUIDE WHEEL SHAFT	6	88-3	SQUARE KEY 5*5*12	1			
35	SCREW M4*8	1	65	DECORATIVE COVERS 1	3	89	O RING	1			
36	BRUSH HOLDER ASSEMBLY	2	66	BRACKET IRON SLEEVE	16	90	OIL GLASS	1			